

see thoroughly,

insure safety

EVOLUTION E+ series



remote controlled tables

Ergonomics

Functionality

Compactness

stephani
RADIOLOGICAL SOLUTIONS



EVOLUTION E+ series

remote controlled tables

EVOLUTION E+ series is a wide range of compact remote controlled tables, designed for all radiographic and fluoroscopic examinations. Image intensifiers from 9" to 16" can be used throughout the whole range of EVOLUTION E+ series either in fluoroscopy or digital mode.

In addition to traditional use with image intensifiers, EVOLUTION E+ may be equipped with either Computer Radiography (C.R.) or Direct Radiography (D.R.) with flat panel sensor up to 17" x 17" technologies.

From conventional to digital imaging, STEPHANIX brings you new technologies for better efficiency.

ERGONOMICS
ERGONOMICS



see thoroughly, insure safety

The controls are ergonomically placed to optimise ease and speed of operation. All major movements are controlled by user-friendly joysticks allowing for easily managed proportional motion speed. This feature enables precise patient positioning.



FUNCTIONALITY

The lateral tabletop travel with the column tubestand movement thereby provide a wide patient coverage of 180 cm (X-ray beam).

Variable SID, continuous from 110 cm to 150 cm, permits operator technique value selection for specific examinations in both fluoroscopy and radiography.

Available with variable height movement controls (HV models), the tabletop will range

from 76 cm to 106 cm. At its lowest position, both patient and operator ease of positioning is achieved and even wheelchair.

As many as four pre-programmed heights are available to suit your standard needs.



All procedures with incidences can be done with EVOLUTION E+ I and EVOLUTION E+ I HV.

The column's tilting capability is +/- 40° for radiographic, fluoroscopic and tomographic examinations.

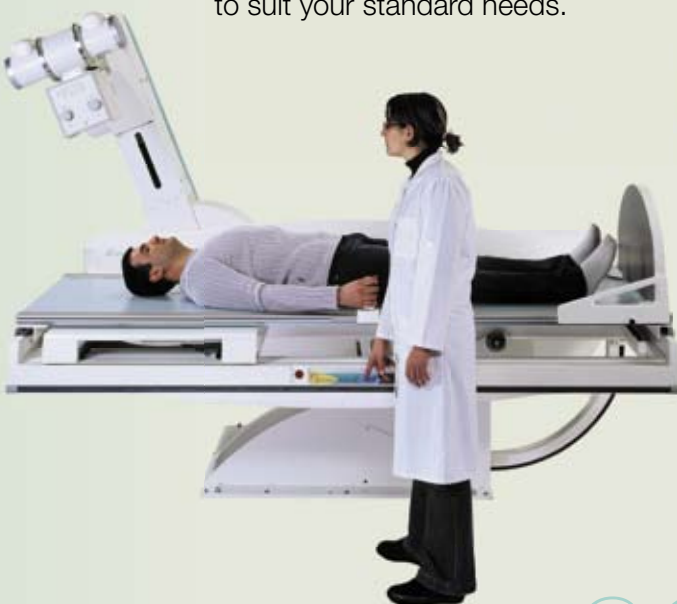

COMPACTNESS

Technical specifications

	EVOLUTION E+	EVOLUTION E+ HV
Tilting	+90°/-15°	+90°/-30°
Tilting time	from 0° to 90° in 20 s	
Tabletop	flat	
Dimensions	240 x 81 cm	
Height	88 cm	from 76 cm to 106 cm
Lateral movement	30 cm anti-collision safeties	
Source Image Distance	from 110 cm to 150 cm in continuous rotation +/- 180°	
X-ray tube	+/- 40° parallax correction	
Column incidences	three angles from 8° to 40° layer height from 0 to 300 mm, by step of 1 mm automatic layer height increment	
Tomography		
Serial changer	longitudinal movement of 140 cm patient scanning of 180 cm (x-ray beam)	
Dimensions and weights		
Table	(L x W) 240 x 170 cm - 1,000 kg	(L x W) 240 x 170 - 1,200 kg
Cabinet	(L x D x W) 54.5 x 53.5 x 192.5 - 200 kg	
Control console	(L x D x W) 32.7 x 36.1 x 18.5 cm - 8 kg	

EVOLUTION E+ I
EVOLUTION E+ I HV

Layout example

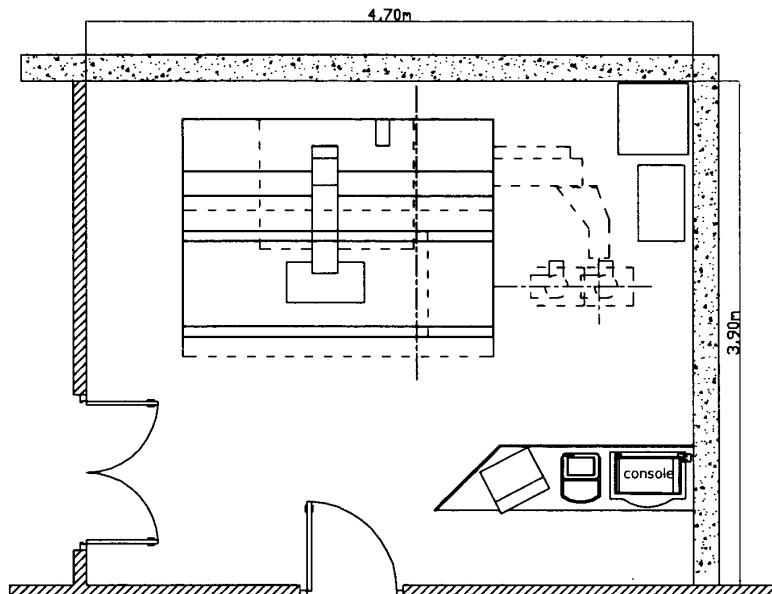

Head Office
47-49, rue Eugène Beaune
42005 Saint-Etienne cedex 01 - FRANCE
Tel : + 33 4 77 47 81 60
Fax : + 33 4 77 37 55 19

www.stephanix.com

Export Department
15, rue du Saule Trapu
91882 Massy cedex - FRANCE
Tel : + 33 1 60 13 56 25
Fax : + 33 1 60 13 56 30